

\*RoHS COMPLIANT

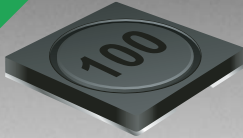

**BOURNS®**

## Features

- Available in E6 values
- Mounting height of only 1.15 mm
- Inductance value to 1.5 µH
- RoHS compliant\*

## Applications

- Input/output of DC/DC converters
- Power supplies for:
  - Portable communication equipment
  - Camcorders
  - LCD TVs
  - Car radios

# SRR3011 Series - Shielded SMD Power Inductors

### Electrical Specifications

| Bourns Part No. | Inductance 100 kHz |        | Q<br>Typ. | Test<br>Frequency<br>(MHz) | SRF<br>Min.<br>(MHz) | RDC<br>Max.<br>(Ω) | I rms<br>Max.<br>(A) | I sat<br>Typ.<br>(A) |
|-----------------|--------------------|--------|-----------|----------------------------|----------------------|--------------------|----------------------|----------------------|
|                 | (µH)               | Tol. % |           |                            |                      |                    |                      |                      |
| SRR3011-1R5YL   | 1.50               | ± 30   | 11        | 7.96                       | 124                  | 0.055              | 1.60                 | 1.30                 |
| SRR3011-2R5YL   | 2.50               | ± 30   | 7         | 7.96                       | 112                  | 0.085              | 1.20                 | 1.00                 |
| SRR3011-3R3YL   | 3.30               | ± 30   | 8         | 7.96                       | 101                  | 0.090              | 1.00                 | 0.85                 |
| SRR3011-4R7YL   | 4.70               | ± 30   | 9         | 7.96                       | 69                   | 0.125              | 0.90                 | 0.75                 |
| SRR3011-6R8YL   | 6.80               | ± 30   | 10        | 7.96                       | 49                   | 0.210              | 0.72                 | 0.62                 |
| SRR3011-100YL   | 10.0               | ± 30   | 18        | 2.52                       | 42                   | 0.280              | 0.65                 | 0.50                 |
| SRR3011-150YL   | 15.0               | ± 20   | 16        | 2.52                       | 37                   | 0.420              | 0.48                 | 0.38                 |
| SRR3011-220YL   | 22.0               | ± 20   | 11        | 2.52                       | 31                   | 0.680              | 0.38                 | 0.32                 |
| SRR3011-330YL   | 33.0               | ± 20   | 14        | 2.52                       | 25                   | 0.860              | 0.32                 | 0.27                 |
| SRR3011-470YL   | 47.0               | ± 20   | 16        | 2.52                       | 18                   | 1.800              | 0.27                 | 0.23                 |
| SRR3011-680YL   | 68.0               | ± 20   | 14        | 2.52                       | 15                   | 2.250              | 0.22                 | 0.18                 |
| SRR3011-101YL   | 100.0              | ± 20   | 39        | 0.796                      | 13                   | 3.600              | 0.18                 | 0.15                 |

### General Specifications

Test Voltage.....0.1 V  
 Reflow Soldering ...230 °C, 50 sec. max.  
 Operating Temperature -40 °C to +125 °C  
 (Temperature rise included)  
 Storage Temperature...-40 °C to +125 °C  
 Resistance to Soldering Heat  
 .....260 °C for 10 sec.

### Materials

Core .....Ferrite DR and RI  
 Wire .....Enameled copper wire 130  
 Terminal.....Ag/Ni/Sn  
 Rated Current  
 .....Ind. drop 35 % typ. at Isat  
 Temperature Rise .....30 °C max.  
 at rated I rms  
 Packaging .....1200 pcs. per reel

### Electrical Schematic

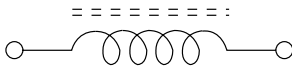

### Recommended Layout

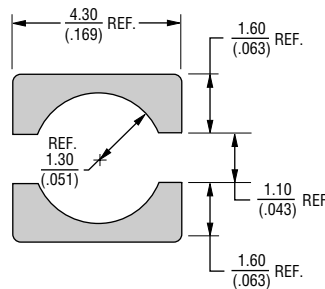

### Product Dimensions

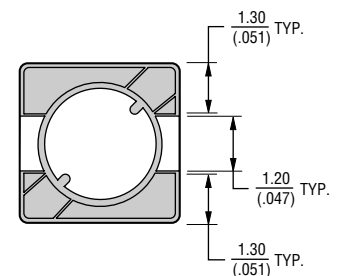
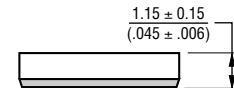
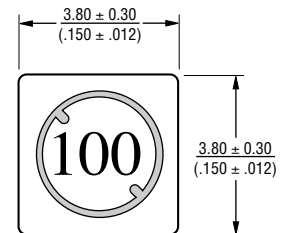

DIMENSIONS:  $\frac{\text{MM}}{\text{(INCHES)}}$

\*RoHS Directive 2002/95/EC Jan 27 2003 including Annex  
 Specifications are subject to change without notice.  
 Customers should verify actual device performance in their specific applications.

# SRR3011 Series - Shielded SMD Power Inductors

**BOURNS®**

## Packaging Specifications

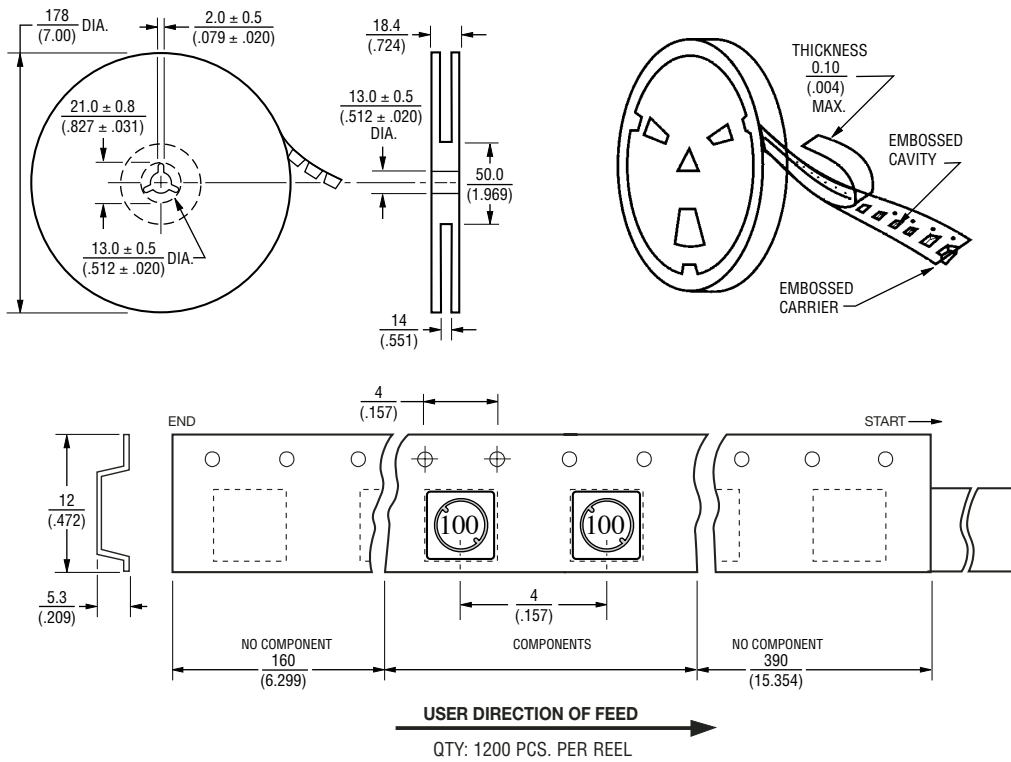

DIMENSIONS:  $\frac{\text{MM}}{\text{(INCHES)}}$

REV. 05/05

Specifications are subject to change without notice.  
Customers should verify actual device performance in their specific applications.